



PNEUMATIC AUTOMATION

CYLINDERS
HIGH-TECH
VALVES
AIR TREATMENT
ACCESSORIES



AUTOMOTIVE

POWER CLAMPS
PIN UNITS
PIN CLAMPS
GRIPPER UNITS
POWER PIVOTS
MARKING UNITS
ELECTRIC UNITS



MODULAR TOOLING SYSTEM

GR8 TOOLING

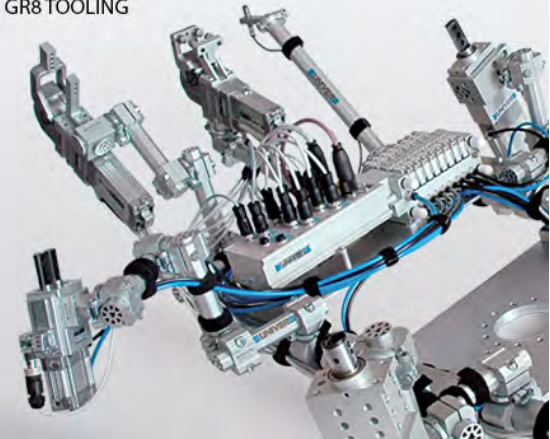

PNEUMATIC AUTOMATION

AUTOMOTIVE

MODULAR TOOLING SYSTEM



COMPLETE PRODUCT RANGE

PNEUMATIC AUTOMATION

Cylinders



High-Tech



Valves



Air treatment



Accessories



AUTOMOTIVE

Power clamp



Pin units



Pin clamps



Gripper units



Power pivots



Marking units



Complementar
y products



Electric units



MODULAR TOOLING SYSTEM

GR8 Tooling



PNEUMATIC AUTOMATION

AUTOMOTIVE

MODULAR TOOLING SYSTEM



AUTOMOTIVE

POWER CLAMPS

PIN UNITS

PIN CLAMPS

GRIPPER UNITS

POWER PIVOTS

MARKING UNITS

ELECTRIC UNITS





PNEUMATIC POWER CLAMPS

➤ UBP25

Universal clamp
Ø 25 mm



➤ UBP32

Universal clamp
Ø 32 mm



➤ UBH40

Universal clamp
Ø 40 mm



➤ IBP40

Interchangeable with size
50-63 mm



**N.A.A.M.S. Standard
Available**

➤ UBP50

Universal clamp
Ø 50 mm



➤ UBP63 / UBH63

Universal clamp
Ø 63 mm



➤ UBP80

Universal clamp
Ø 80 mm



➤ UDP40

2 arms clamp
Ø 40 mm



➤ UDP63

2 arms clamp
Ø 63 mm





PNEUMATIC POWER CLAMPS WITH **HANDLEVER**

- **UBM25-32**
Universal clamp
Ø 25-32 mm



- **UBQ40**
Universal clamp
Ø 40 mm



- **IBM40**
Interchangeable with Ø 50-63 mm



- **UFL/UHL**
Manual clamp



- **UBM50 - 63 - 80**
Universal clamp
Ø 50-63-80 mm



- **UNM50-63-80**
Ø 50-63-80 mm

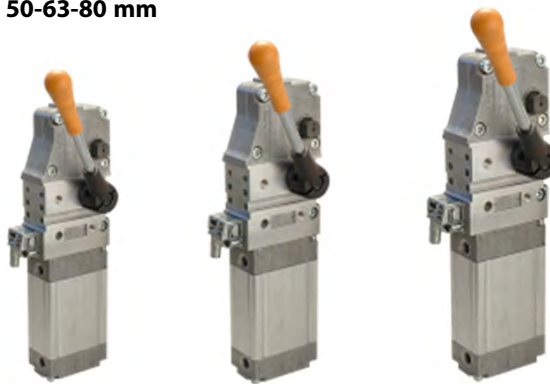

N.A.A.M.S. Standard

Pneumatic Power Clamp applications



AUTOMOTIVE



POWER CLAMPS **BENEFITS**

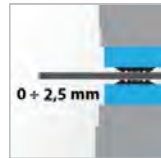

Integrated Compensation system



Unique linkage design ensures positional repeatability



Linear and rotary motion guided by roller bearings



All metal body optical sensor



Pneumatic ports on both sides of the cylinder

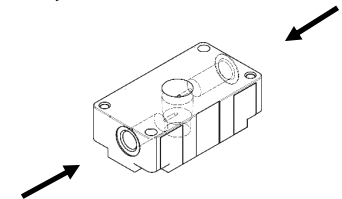

Stepless adjustment of the opening angle



PNEUMATIC GRIPPERS

➤ **UGP**
Ø 40 mm



➤ **UGM**
With handlever
Ø 40 mm



➤ **LGPS**
Ø 32-40 mm





PNEUMATIC GRIPPERS BENEFITS:



Irreversible

Holding the workpiece **tight**
in absence of air

(PATENT PENDING)



Safe

Holding the workpiece **steady**
even if affected by strong
vibrations



Lightweight

The **lightest** among
market equivalent devices

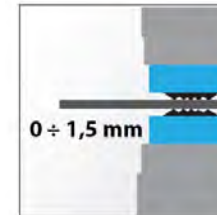

Integrated compensation

Compensating thickness differences
up to 1,5 mm

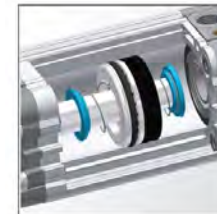

Integrated cushioning

Pneumatic adjustable
(standard supplied)



No maintenance required

Granted millions
of operations or cycles



RETRACTABLE LOCATING PIN UNITS - SINGLE ROD

➤ LCP32



➤ LCP50



➤ LCP63



➤ LCZ40

With toggle-joint mechanism



➤ LCG50

CNOMO



➤ LCG63

CNOMO





RETRACTABLE LOCATING PIN UNITS - TWO RODS

➤ **LCA40**



➤ **LCA63**



➤ **LCT50**

With toggle-joint mechanism



RETRACTABLE LOCATING PIN UNITS - WITH HANDLEVER

➤ **LCM50**



➤ **LCL**



➤ **LCY40**

With toggle-joint mechanism



➤ **LCO**

With double rod



➤ **LCX50**

With toggle-joint mechanism





PIN UNIT **BENEFITS**

- **Metal rodscraper** to avoid welding debris
- **Chromium-plated rods**
- **Antirotation system (single rod)**
- **Same sensor for the whole range**
- **Orientable rods**

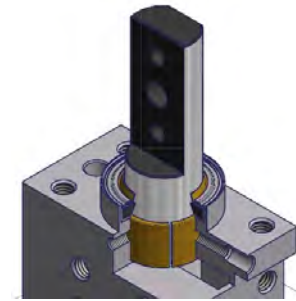



PNEUMATIC PIN CLAMPS

➤ **LSP32/LSP60**



➤ **LSP50U**

Horizontal shape



➤ **LTP50**

Vanishing hook



➤ **LUP63**

Vanishing hook and locating pin



➤ **LSC**

Compact pin clamps



Pin clamp applications



AUTOMOTIVE



PIN CLAMPS **BENEFITS**

- **Toggle-joint linkage**
- **Compensation from 1,5 to 2,5 mm**
- **Scraper system:** the complete movement of the hook is protected against welding debris



POWER PIVOTS

➤ LAGP063



➤ LAGP075



➤ LAGP080



➤ LAGP120



➤ LAGP155



➤ LAGP170



➤ LAGP210-215



➤ LAGP300-350-355



➤ LAGP600-605





POWER PIVOT **BENEFITS**

- **Positional repeatability**
- Brake system **Original** by **UNIVER**
- **Unidirectional valve** for flow optimisation



MARKING UNITS

➤ **PRP025/050**
Single character



➤ **PRP500/1100**
7-8 characters

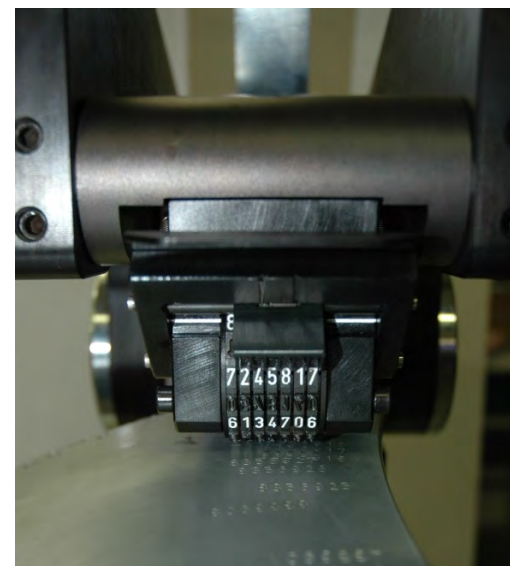

Marking units applications

AUTOMOTIVE



ELECTRIC RANGE

➤ **LAE 140-250-350-950**



➤ **LNE225-350-950**
N.A.A.M.S. Standard



➤ **LGE**
Gripper units



➤ **LCE**
Retractable locating
pin units



➤ **Electric
Power pivots**

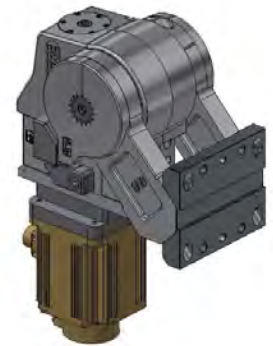

Pneumatic and electric
Power Clamp applications

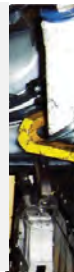

AUTOMOTIVE



MODULAR TOOLING SYSTEM

GR8 TOOLING

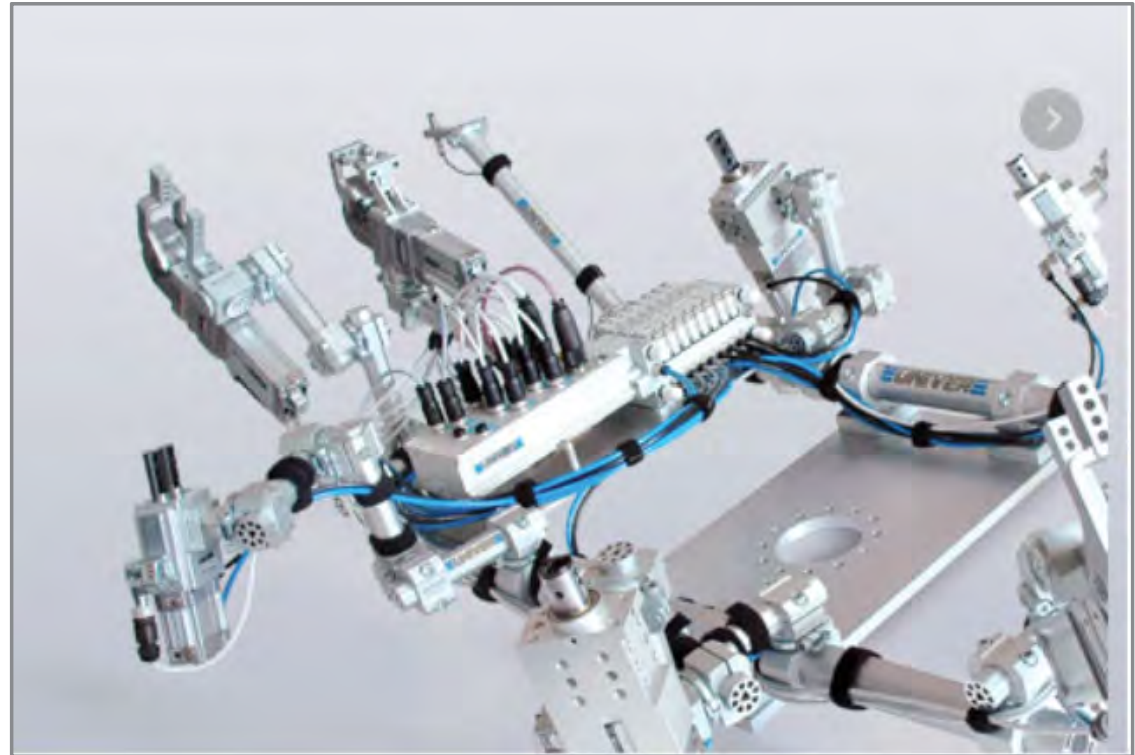



GR8

Modular **Tooling** System

HIGH PRECISION

High level of positional repeatability;
low deflection

MODULAR COMPONENTS

Considerable reduction of mounting components

QUICK INSTALLATION AND SET-UP

No welding or doweling required,
easily replaceable components

FULLY ADJUSTABLE

Unlimited orientation in space and free configuration





Ø 30 - 45 - 70 mm BOOMS

Maximum stiffness and minimum weight



LOCKING RING

Precise and efficient system to guarantee a high level of positional accuracy



BALL MOUNTING

Unlimited swivel rotation





GR8

Application examples

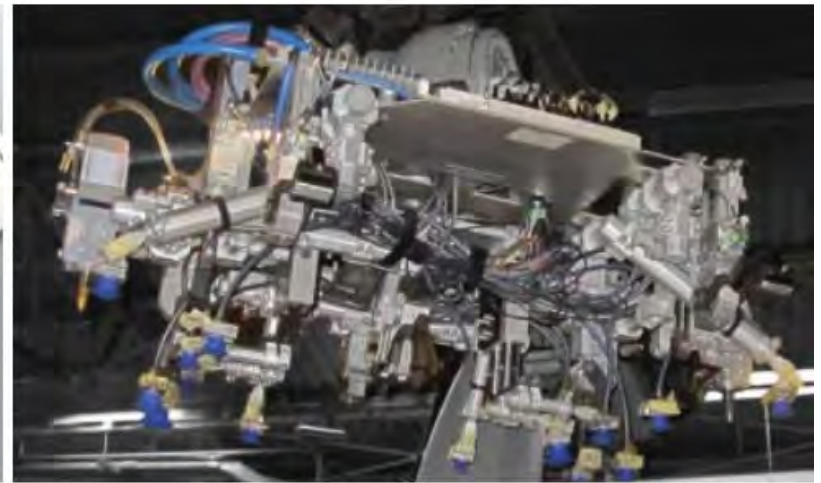
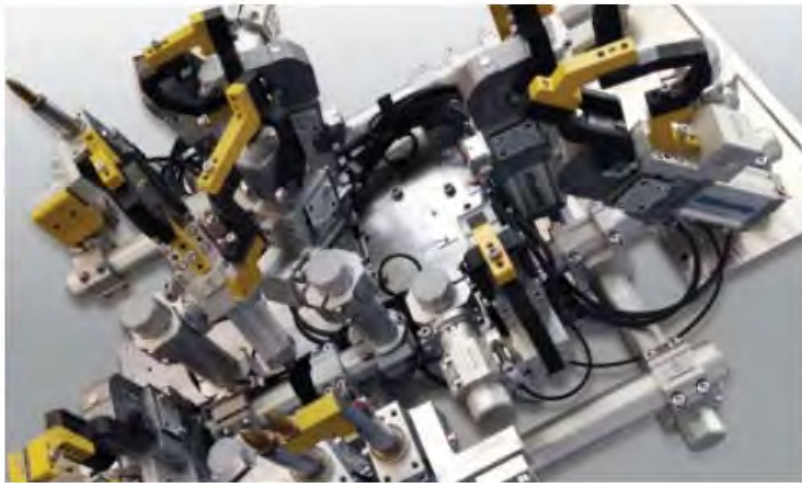

COMPLETE SOLUTION WITH
UNIVER COMPONENTS

Unlimited and complex configurations
Weight-optimized standard components and brackets
Quick installation and adjustment
Modular components



THANK YOU FOR YOUR ATTENTION!

In our web site www.univer-group.com you can find:

- More details about products
- CAD 2D/3D
- Complete sales network
- Project Books
- Certification and Drives
- News and Events